

Harding Steel, Inc.
Mechanical and Automated Parking Systems

CARPARX® ST-2 AND ST-2C

SUBTERRANEAN VEHICLE PARKING AND STORAGE SYSTEMS

DESIGNED FOR TODAY'S LARGEST CARS, TRUCKS AND VINTAGE AUTOMOBILES

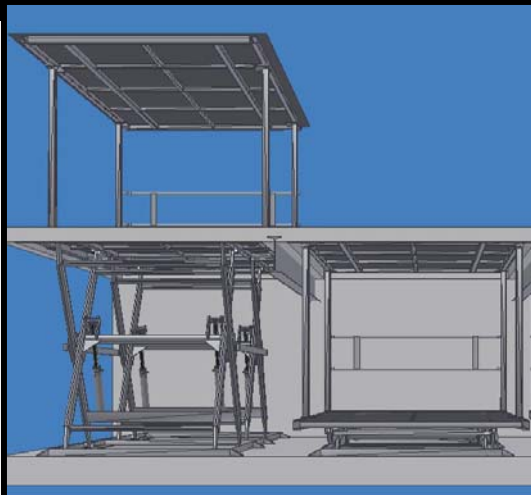
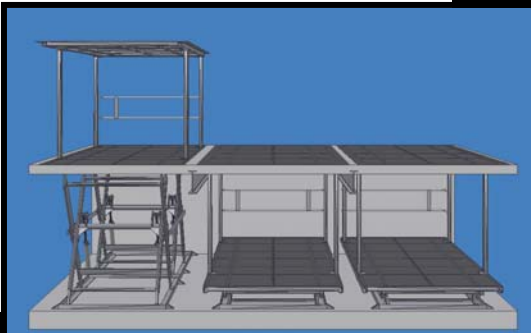

SECURITY

CONVENIENCE

SAFETY

EASE OF USE



Expand the parking capacity of your residence with safe affordable parking lifts from Harding Steel
Quality Parking Systems since 1968

Harding Steel inc, 1751 Gilpin Street, Denver, CO 80218-1205
303-762-9500 Fax: 303-733-4177
Sales: 1-800-PARK-DBL, www.hardingsteel.com
Copyright 2005 Harding Steel, Inc. All Rights Reserved

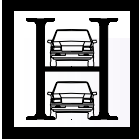

ELEGANT UNDERGROUND GARAGES FOR DISCRIMINATING OWNERS AND COLLECTORS

Features

- 100% premium steel construction
- Commercial grade design and materials
- Dual scissors architecture for unsurpassed stability
- Four high capacity hydraulic cylinders
- Self-standing, self-supporting unit
- Suitable for indoor or outdoor installation
- 220V high flow hydraulic power pack and controls
- Oversized all diamond-plate steel platforms
- Accommodates full size SUVs on both levels
- Available in three models (Sedan, Extra, SUV)
- Quality enamel paint finish throughout

Safety

- Platforms are free of all trip hazards, pit gaps, or protruding columns
- Key-operated control switch for security and safety
- Hydraulic velocity fuses on all cylinders
- Automatic shut-off if operator releases the key-switch
- Wiring block for integrating safety interlock devices
- Front railing protects garage walls and bumpers
- Optional sensor and interlock kit available

Dimensions

- Upper platform: 234"L x 102"W
- Lower platform: 228"L x 94"W (will fit a 2005 Chevy Suburban)
- Interplatform clearance (clear space between platforms):
 - Sedan: 66"
 - Extra: 72"
 - SUV: 78"
- Minimum pit depth (finished floor to finished floor)
 - Sedan: 84"
 - Extra: 90"
 - SUV 96"
- Ceiling clearance requirements (to raise unit with upper car in place)
 - Sedan: 73" plus height of upper car
 - Extra: 79" plus height of upper car
 - SUV: 85" plus height of upper car
- Drive-in clearance (between rear posts): 88"
- Weight Capacities:
 - Lower car: 7000 lbs.
 - Upper car: 7000 lbs
- Approximate machine weight: 8000 lbs.
- Electrical Power Requirement: 220V, single-phase, 30 amp circuit
- Shipping and Installation:
 - Shipped by common carrier to most locations in US and Canada
 - Installed by factory technicians
- Warranty
 - One year electrical, two year mechanical, five year structural

*All specifications are subject to change and must be reviewed for every installation

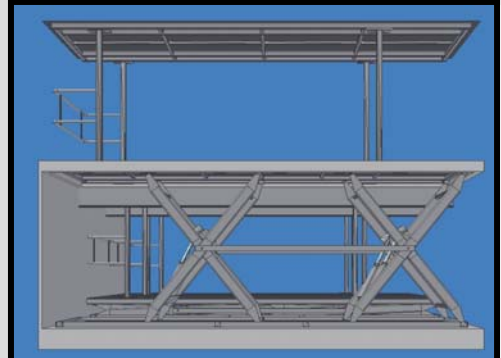



ENGINEERED FOR NEW CONSTRUCTION OR RETROFIT APPLICATIONS

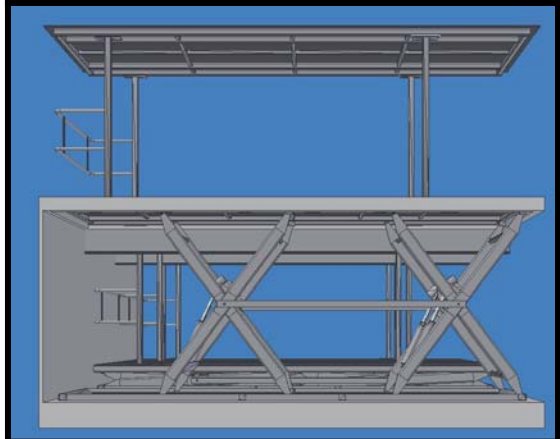
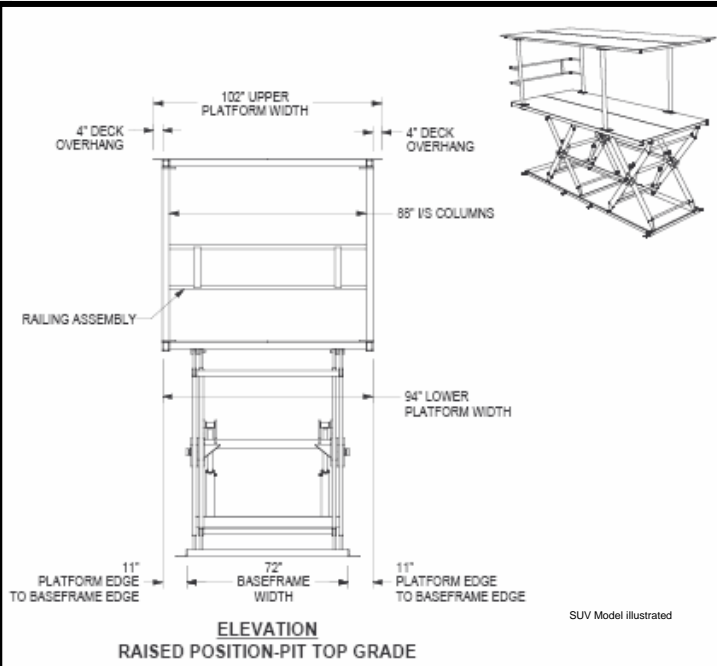
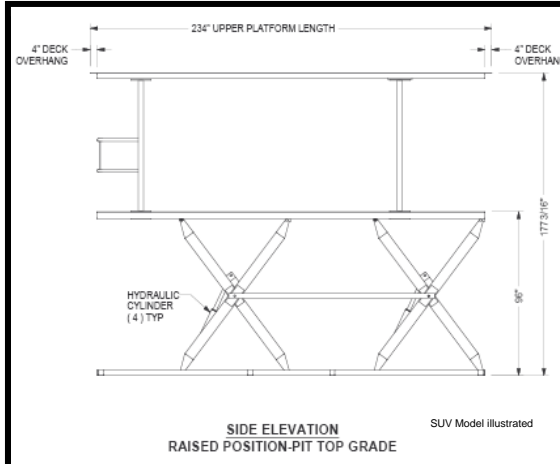

CARPARX® ST-2 AND ST-2C
SUBTERRANEAN VEHICLE SYSTEMS

